

ELEVATION CERTIFICATE

IMPORTANT: Follow the instructions on pages 1-9.

OMB No. 1660-0008
 Expiration Date: July 31, 2015

| SECTION A - PROPERTY INFORMATION | | | FOR INSURANCE COMPANY USE |
|---|---|--|---------------------------|
| A1. Building Owner's Name <u>The Housing Authority of the City of Waveland</u> | | Policy Number: | |
| A2. Building Street Address (including Apt., Unit, Suite, and/or Bldg. No.) or P.O. Route and Box No. <u>529 Camille Circle</u> | | Company NAIC Number: | |
| City <u>Waveland</u> | State <u>MS</u> | ZIP Code <u>39576</u> | |
| A3. Property Description (Lot and Block Numbers, Tax Parcel Number, Legal Description, etc.) <u>Part of Tax Parcel #162H-0-03-018.00 (building 11)</u> | | | |
| A4. Building Use (e.g., Residential, Non-Residential, Addition, Accessory, etc.) <u>Residential</u> | | | |
| A5. Latitude/Longitude: Lat. <u>30d17'13.3"</u> Long. <u>89d22'41.7"</u> | | Horizontal Datum: <input type="checkbox"/> NAD 1927 <input checked="" type="checkbox"/> NAD 1983 | |
| A6. Attach at least 2 photographs of the building if the Certificate is being used to obtain flood insurance. | | | |
| A7. Building Diagram Number <u>1A</u> | | | |
| A8. For a building with a crawlspace or enclosure(s): | | A9. For a building with an attached garage: | |
| a) Square footage of crawlspace or enclosure(s) <u>na</u> sq ft | a) Square footage of attached garage <u>na</u> sq ft | | |
| b) Number of permanent flood openings in the crawlspace or enclosure(s) within 1.0 foot above adjacent grade <u>na</u> | b) Number of permanent flood openings in the attached garage within 1.0 foot above adjacent grade <u>na</u> | | |
| c) Total net area of flood openings in A8.b <u>na</u> sq in | c) Total net area of flood openings in A9.b <u>na</u> sq in | | |
| d) Engineered flood openings? <input type="checkbox"/> Yes <input checked="" type="checkbox"/> No | d) Engineered flood openings? <input type="checkbox"/> Yes <input checked="" type="checkbox"/> No | | |

SECTION B - FLOOD INSURANCE RATE MAP (FIRM) INFORMATION

| | | | | | |
|---|------------------------|--|---|--------------------------------|--|
| B1. NFIP Community Name & Community Number <u>City of Waveland 285262</u> | | | B2. County Name <u>Hancock</u> | | B3. State <u>Ms</u> |
| B4. Map/Panel Number <u>28045C0342</u> | B5. Suffix <u>D</u> | B6. FIRM Index Date <u>10/16/2009</u> | B7. FIRM Panel Effective/ Revised Date <u>10/16/2009</u> | B8. Flood Zone(s) <u>AE</u> | B9. Base Flood Elevation(s) (Zone AO, use base flood depth) <u>18</u> |
| B10. Indicate the source of the Base Flood Elevation (BFE) data or base flood depth entered in Item B9: <input type="checkbox"/> FIS Profile <input checked="" type="checkbox"/> FIRM <input type="checkbox"/> Community Determined <input type="checkbox"/> Other/Source: _____ | | | | | |
| B11. Indicate elevation datum used for BFE in Item B9: <input type="checkbox"/> NGVD 1929 <input checked="" type="checkbox"/> NAVD 1988 <input type="checkbox"/> Other/Source: _____ | | | | | |
| B12. Is the building located in a Coastal Barrier Resources System (CBRS) area or Otherwise Protected Area (OPA)? <input type="checkbox"/> Yes <input checked="" type="checkbox"/> No Designation Date: _____ / _____ / _____ <input type="checkbox"/> CBRS <input type="checkbox"/> OPA | | | | | |

SECTION C - BUILDING ELEVATION INFORMATION (SURVEY REQUIRED)

C1. Building elevations are based on: Construction Drawings* Building Under Construction* Finished Construction
 *A new Elevation Certificate will be required when construction of the building is complete.

C2. Elevations - Zones A1-A30, AE, AH, A (with BFE), VE, V1-V30, V (with BFE), AR, AR/A, AR/AE, AR/A1-A30, AR/AH, AR/AO. Complete Items C2.a-h below according to the building diagram specified in Item A7. In Puerto Rico only, enter meters.
 Benchmark Utilized: GPS RTK-Trimble VRS Network Vertical Datum: NAVD 1988

Indicate elevation datum used for the elevations in items a) through h) below. NGVD 1929 NAVD 1988 Other/Source: _____
 Datum used for building elevations must be the same as that used for the BFE.

| | | |
|--|-----------------------|--|
| a) Top of bottom floor (including basement, crawlspace, or enclosure floor) | <u>19</u> . <u>6</u> | <input checked="" type="checkbox"/> feet <input type="checkbox"/> meters |
| b) Top of the next higher floor | <u>na</u> . _____ | <input type="checkbox"/> feet <input type="checkbox"/> meters |
| c) Bottom of the lowest horizontal structural member (V Zones only) | <u>na</u> . _____ | <input type="checkbox"/> feet <input type="checkbox"/> meters |
| d) Attached garage (top of slab) | <u>na</u> . _____ | <input type="checkbox"/> feet <input type="checkbox"/> meters |
| e) Lowest elevation of machinery or equipment servicing the building (Describe type of equipment and location in Comments) | <u>19</u> . <u>5</u> | <input checked="" type="checkbox"/> feet <input type="checkbox"/> meters |
| f) Lowest adjacent (finished) grade next to building (LAG) | <u>18</u> . <u>50</u> | <input checked="" type="checkbox"/> feet <input type="checkbox"/> meters |
| g) Highest adjacent (finished) grade next to building (HAG) | <u>19</u> . <u>00</u> | <input checked="" type="checkbox"/> feet <input type="checkbox"/> meters |
| h) Lowest adjacent grade at lowest elevation of deck or stairs, including structural support | <u>na</u> . _____ | <input type="checkbox"/> feet <input type="checkbox"/> meters |

SECTION D - SURVEYOR, ENGINEER, OR ARCHITECT CERTIFICATION

This certification is to be signed and sealed by a land surveyor, engineer, or architect authorized by law to certify elevation information. I certify that the information on this Certificate represents my best efforts to interpret the data available. I understand that any false statement may be punishable by fine or imprisonment under 18 U.S. Code, Section 1001.

Check here if comments are provided on back of form. Were latitude and longitude in Section A provided by a licensed land surveyor? Yes No
 Check here if attachments.

| | | | |
|---|--|---------------------------------------|------------------------------------|
| Certifier's Name <u>Paul A. Liles</u> | | License Number <u>3174</u> | |
| Title <u>Professional Surveyor</u> | | Company Name <u>Machado Patano</u> | |
| Address <u>1641 Poppys Ferry Road, Suite A-4</u> | | City <u>Biloxi</u> | State <u>MS</u> |
| Signature <u>Paul A. Liles</u> | | ZIP Code <u>39532</u> | Telephone <u>(228) 388-1950</u> |
| Date <u>06/02/2016</u> | | | |

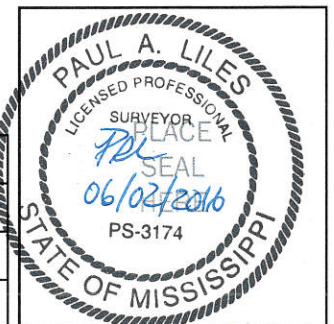

ELEVATION CERTIFICATE, page 2

| | | | | |
|---|-------------|-------------------|----------------------------------|--|
| IMPORTANT: In these spaces, copy the corresponding information from Section A. | | | FOR INSURANCE COMPANY USE | |
| Building Street Address (including Apt., Unit, Suite, and/or Bldg. No.) or P.O. Route and Box No. 529 Camille Circle | | | Policy Number: | |
| City Waveland | State MS | ZIP Code 39576 | Company NAIC Number: | |

SECTION D – SURVEYOR, ENGINEER, OR ARCHITECT CERTIFICATION (CONTINUED)

Copy both sides of this Elevation Certificate for (1) community official, (2) insurance agent/company, and (3) building owner.

Comments C2a = building slab elevation. C2e= air conditioner pad. C2f and g)=existing grades

Signature *Fair G D* Date 06/02/2016

SECTION E – BUILDING ELEVATION INFORMATION (SURVEY NOT REQUIRED) FOR ZONE AO AND ZONE A (WITHOUT BFE)

For Zones AO and A (without BFE), complete Items E1–E5. If the Certificate is intended to support a LOMA or LOMR-F request, complete Sections A, B, and C. For Items E1–E4, use natural grade, if available. Check the measurement used. In Puerto Rico only, enter meters.

- E1. Provide elevation information for the following and check the appropriate boxes to show whether the elevation is above or below the highest adjacent grade (HAG) and the lowest adjacent grade (LAG).
- a) Top of bottom floor (including basement, crawlspace, or enclosure) is _____ feet meters above or below the HAG.
 - b) Top of bottom floor (including basement, crawlspace, or enclosure) is _____ feet meters above or below the LAG.
- E2. For Building Diagrams 6–9 with permanent flood openings provided in Section A Items 8 and/or 9 (see pages 8–9 of Instructions), the next higher floor (elevation C2.b in the diagrams) of the building is _____ feet meters above or below the HAG.
- E3. Attached garage (top of slab) is _____ feet meters above or below the HAG.
- E4. Top of platform of machinery and/or equipment servicing the building is _____ feet meters above or below the HAG.
- E5. Zone AO only: If no flood depth number is available, is the top of the bottom floor elevated in accordance with the community's floodplain management ordinance? Yes No Unknown. The local official must certify this information in Section G.

SECTION F – PROPERTY OWNER (OR OWNER'S REPRESENTATIVE) CERTIFICATION

The property owner or owner's authorized representative who completes Sections A, B, and E for Zone A (without a FEMA-issued or community-issued BFE) or Zone AO must sign here. The statements in Sections A, B, and E are correct to the best of my knowledge.

Property Owner or Owner's Authorized Representative's Name _____

| | | | |
|-----------------|------------|-----------------|----------------|
| Address _____ | City _____ | State _____ | ZIP Code _____ |
| Signature _____ | Date _____ | Telephone _____ | |

Comments _____ Check here if attachments.

SECTION G – COMMUNITY INFORMATION (OPTIONAL)

The local official who is authorized by law or ordinance to administer the community's floodplain management ordinance can complete Sections A, B, C (or E), and G of this Elevation Certificate. Complete the applicable item(s) and sign below. Check the measurement used in Items G8–G10. In Puerto Rico only, enter meters.

- G1. The information in Section C was taken from other documentation that has been signed and sealed by a licensed surveyor, engineer, or architect who is authorized by law to certify elevation information. (Indicate the source and date of the elevation data in the Comments area below.)
- G2. A community official completed Section E for a building located in Zone A (without a FEMA-issued or community-issued BFE) or Zone AO.
- G3. The following information (Items G4–G10) is provided for community floodplain management purposes.

| | | |
|-------------------------|------------------------------|---|
| G4. Permit Number _____ | G5. Date Permit Issued _____ | G6. Date Certificate Of Compliance/Occupancy Issued _____ |
|-------------------------|------------------------------|---|

G7. This permit has been issued for: New Construction Substantial Improvement

G8. Elevation of as-built lowest floor (including basement) of the building: _____ feet meters Datum _____

G9. BFE or (in Zone AO) depth of flooding at the building site: _____ feet meters Datum _____

G10. Community's design flood elevation: _____

Local Official's Name _____ Title _____

Community Name _____ Telephone _____

Signature _____ Date _____

Comments _____

Check here if attachments.

BUILDING PHOTOGRAPHS

See Instructions for Item A6.

| | | | |
|---|-------------|-------------------|----------------------------------|
| IMPORTANT: In these spaces, copy the corresponding information from Section A. | | | FOR INSURANCE COMPANY USE |
| Building Street Address (including Apt., Unit, Suite, and/or Bldg. No.) or P.O. Route and Box No. 529 Camille Circle | | | Policy Number: |
| City Waveland | State MS | ZIP Code 39576 | Company NAIC Number: |

If using the Elevation Certificate to obtain NFIP flood insurance, affix at least 2 building photographs below according to the instructions for Item A6. Identify all photographs with date taken; "Front View" and "Rear View"; and, if required, "Right Side View" and "Left Side View." When applicable, photographs must show the foundation with representative examples of the flood openings or vents, as indicated in Section A8. If submitting more photographs than will fit on this page, use the Continuation Page.

FRONT VIEW 06/01/2016



| | | | |
|---|-------------|-------------------|---------------------------|
| IMPORTANT: In these spaces, copy the corresponding information from Section A. | | | FOR INSURANCE COMPANY USE |
| Building Street Address (including Apt., Unit, Suite, and/or Bldg. No.) or P.O. Route and Box No. 529 Camille Circle | | | Policy Number: |
| City Waveland | State MS | ZIP Code 39576 | Company NAIC Number: |

If submitting more photographs than will fit on the preceding page, affix the additional photographs below. Identify all photographs with: date taken; "Front View" and "Rear View"; and, if required, "Right Side View" and "Left Side View." When applicable, photographs must show the foundation with representative examples of the flood openings or vents, as indicated in Section A8.

REAR VIEW 06/01/2016



ELEVATION CERTIFICATE

IMPORTANT: Follow the instructions on pages 1-9.

OMB No. 1660-0008
 Expiration Date: July 31, 2015

| SECTION A - PROPERTY INFORMATION | | FOR INSURANCE COMPANY USE |
|---|-----------------|---|
| A1. Building Owner's Name The Housing Authority of the City of Waveland | | Policy Number: |
| A2. Building Street Address (including Apt., Unit, Suite, and/or Bldg. No.) or P.O. Route and Box No. 529 Camille Circle | | Company NAIC Number: |
| City Waveland | State MS | ZIP Code 39576 |
| A3. Property Description (Lot and Block Numbers, Tax Parcel Number, Legal Description, etc.) Part of Tax Parcel #162H-0-03-018.00 (building 11) | | |
| A4. Building Use (e.g., Residential, Non-Residential, Addition, Accessory, etc.) <u>Residential</u> | | |
| A5. Latitude/Longitude: Lat. <u>30d17'13.3"</u> Long. <u>89d22'41.7"</u> Horizontal Datum: <input type="checkbox"/> NAD 1927 <input checked="" type="checkbox"/> NAD 1983 | | |
| A6. Attach at least 2 photographs of the building if the Certificate is being used to obtain flood insurance. | | |
| A7. Building Diagram Number <u>1A</u> | | |
| A8. For a building with a crawlspace or enclosure(s): | | A9. For a building with an attached garage: |
| a) Square footage of crawlspace or enclosure(s) <u>na</u> sq ft | | a) Square footage of attached garage <u>na</u> sq ft |
| b) Number of permanent flood openings in the crawlspace or enclosure(s) within 1.0 foot above adjacent grade <u>na</u> | | b) Number of permanent flood openings in the attached garage within 1.0 foot above adjacent grade <u>na</u> |
| c) Total net area of flood openings in A8.b <u>na</u> sq in | | c) Total net area of flood openings in A9.b <u>na</u> sq in |
| d) Engineered flood openings? <input type="checkbox"/> Yes <input checked="" type="checkbox"/> No | | d) Engineered flood openings? <input type="checkbox"/> Yes <input checked="" type="checkbox"/> No |

| SECTION B - FLOOD INSURANCE RATE MAP (FIRM) INFORMATION | | | | | |
|---|------------------------|--|---|--------------------------------|--|
| B1. NFIP Community Name & Community Number City of Waveland 285262 | | | B2. County Name Hancock | | B3. State Ms |
| B4. Map/Panel Number 28045C0342 | B5. Suffix D | B6. FIRM Index Date 10/16/2009 | B7. FIRM Panel Effective/ Revised Date 10/16/2009 | B8. Flood Zone(s) AE | B9. Base Flood Elevation(s) (Zone AO, use base flood depth) 18 |
| B10. Indicate the source of the Base Flood Elevation (BFE) data or base flood depth entered in Item B9: <input type="checkbox"/> FIS Profile <input checked="" type="checkbox"/> FIRM <input type="checkbox"/> Community Determined <input type="checkbox"/> Other/Source: _____ | | | | | |
| B11. Indicate elevation datum used for BFE in Item B9: <input type="checkbox"/> NGVD 1929 <input checked="" type="checkbox"/> NAVD 1988 <input type="checkbox"/> Other/Source: _____ | | | | | |
| B12. Is the building located in a Coastal Barrier Resources System (CBRS) area or Otherwise Protected Area (OPA)? <input type="checkbox"/> Yes <input checked="" type="checkbox"/> No Designation Date: _____ / _____ / _____ <input type="checkbox"/> CBRS <input type="checkbox"/> OPA | | | | | |

| SECTION C - BUILDING ELEVATION INFORMATION (SURVEY REQUIRED) | |
|---|--|
| C1. Building elevations are based on: <input type="checkbox"/> Construction Drawings* <input checked="" type="checkbox"/> Building Under Construction* <input type="checkbox"/> Finished Construction *A new Elevation Certificate will be required when construction of the building is complete. | |
| C2. Elevations - Zones A1-A30, AE, AH, A (with BFE), VE, V1-V30, V (with BFE), AR, AR/A, AR/AE, AR/A1-A30, AR/AH, AR/AO. Complete Items C2.a-h below according to the building diagram specified in Item A7. In Puerto Rico only, enter meters. Benchmark Utilized: <u>GPS RTK-Trimble VRS Network</u> Vertical Datum: <u>NAVD 1988</u> Indicate elevation datum used for the elevations in items a) through h) below. <input type="checkbox"/> NGVD 1929 <input checked="" type="checkbox"/> NAVD 1988 <input type="checkbox"/> Other/Source: _____ Datum used for building elevations must be the same as that used for the BFE. | |
| Check the measurement used. | |
| a) Top of bottom floor (including basement, crawlspace, or enclosure floor) <u>19 . 5</u> | <input checked="" type="checkbox"/> feet <input type="checkbox"/> meters |
| b) Top of the next higher floor <u>na</u> | <input type="checkbox"/> feet <input type="checkbox"/> meters |
| c) Bottom of the lowest horizontal structural member (V Zones only) <u>na</u> | <input type="checkbox"/> feet <input type="checkbox"/> meters |
| d) Attached garage (top of slab) <u>na</u> | <input type="checkbox"/> feet <input type="checkbox"/> meters |
| e) Lowest elevation of machinery or equipment servicing the building (Describe type of equipment and location in Comments) <u>19 . 5</u> | <input checked="" type="checkbox"/> feet <input type="checkbox"/> meters |
| f) Lowest adjacent (finished) grade next to building (LAG) <u>18 . 50</u> | <input checked="" type="checkbox"/> feet <input type="checkbox"/> meters |
| g) Highest adjacent (finished) grade next to building (HAG) <u>18 . 80</u> | <input checked="" type="checkbox"/> feet <input type="checkbox"/> meters |
| h) Lowest adjacent grade at lowest elevation of deck or stairs, including structural support <u>na</u> | <input type="checkbox"/> feet <input type="checkbox"/> meters |

| SECTION D - SURVEYOR, ENGINEER, OR ARCHITECT CERTIFICATION | | | |
|---|---------------------------------------|--|--------------------------|
| This certification is to be signed and sealed by a land surveyor, engineer, or architect authorized by law to certify elevation information. I certify that the information on this Certificate represents my best efforts to interpret the data available. I understand that any false statement may be punishable by fine or imprisonment under 18 U.S. Code, Section 1001. | | | |
| <input checked="" type="checkbox"/> Check here if comments are provided on back of form. | | Were latitude and longitude in Section A provided by a licensed land surveyor? <input checked="" type="checkbox"/> Yes <input type="checkbox"/> No | |
| <input checked="" type="checkbox"/> Check here if attachments. | | | |
| Certifier's Name Paul A. Liles | License Number 3174 | | |
| Title Professional Surveyor | Company Name Machado Patano | | |
| Address 1641 Poppers Ferry Road, Suite A-4 | City Biloxi | State MS | ZIP Code 39532 |
| Signature  | Date 04/01/2016 | Telephone (228) 388-1950 | |

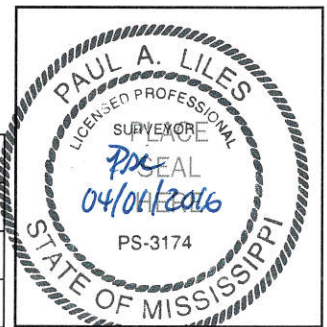

ELEVATION CERTIFICATE, page 2

IMPORTANT: In these spaces, copy the corresponding information from Section A.

Building Street Address (including Apt., Unit, Suite, and/or Bldg. No.) or P.O. Route and Box No.
529 Camille Circle
City Waveland State MS ZIP Code 39576

| | |
|---------------------------|--|
| FOR INSURANCE COMPANY USE | |
| Policy Number: | |
| Company NAIC Number: | |

SECTION D – SURVEYOR, ENGINEER, OR ARCHITECT CERTIFICATION (CONTINUED)

Copy both sides of this Elevation Certificate for (1) community official, (2) insurance agent/company, and (3) building owner.

Comments C2a = building slab elevation. C2e= proposed air conditioner pad. C2f and g)=existing grades

Signature *Paul A. D.*

Date 04/01/2016

SECTION E – BUILDING ELEVATION INFORMATION (SURVEY NOT REQUIRED) FOR ZONE AO AND ZONE A (WITHOUT BFE)

For Zones AO and A (without BFE), complete Items E1–E5. If the Certificate is intended to support a LOMA or LOMR-F request, complete Sections A, B, and C. For Items E1–E4, use natural grade, if available. Check the measurement used. In Puerto Rico only, enter meters.

E1. Provide elevation information for the following and check the appropriate boxes to show whether the elevation is above or below the highest adjacent grade (HAG) and the lowest adjacent grade (LAG).

- a) Top of bottom floor (including basement, crawlspace, or enclosure) is _____ feet meters above or below the HAG.
- b) Top of bottom floor (including basement, crawlspace, or enclosure) is _____ feet meters above or below the LAG.

E2. For Building Diagrams 6–9 with permanent flood openings provided in Section A Items 8 and/or 9 (see pages 8–9 of Instructions), the next higher floor (elevation C2.b in the diagrams) of the building is _____ feet meters above or below the HAG.

E3. Attached garage (top of slab) is _____ feet meters above or below the HAG.

E4. Top of platform of machinery and/or equipment servicing the building is _____ feet meters above or below the HAG.

E5. Zone AO only: If no flood depth number is available, is the top of the bottom floor elevated in accordance with the community's floodplain management ordinance? Yes No Unknown. The local official must certify this information in Section G.

SECTION F – PROPERTY OWNER (OR OWNER'S REPRESENTATIVE) CERTIFICATION

The property owner or owner's authorized representative who completes Sections A, B, and E for Zone A (without a FEMA-issued or community-issued BFE) or Zone AO must sign here. The statements in Sections A, B, and E are correct to the best of my knowledge.

Property Owner or Owner's Authorized Representative's Name _____

Address _____ City _____ State _____ ZIP Code _____

Signature _____ Date _____ Telephone _____

Comments _____

Check here if attachments.

SECTION G – COMMUNITY INFORMATION (OPTIONAL)

The local official who is authorized by law or ordinance to administer the community's floodplain management ordinance can complete Sections A, B, C (or E), and G of this Elevation Certificate. Complete the applicable item(s) and sign below. Check the measurement used in Items G8–G10. In Puerto Rico only, enter meters.

- G1. The information in Section C was taken from other documentation that has been signed and sealed by a licensed surveyor, engineer, or architect who is authorized by law to certify elevation information. (Indicate the source and date of the elevation data in the Comments area below.)
- G2. A community official completed Section E for a building located in Zone A (without a FEMA-issued or community-issued BFE) or Zone AO.
- G3. The following information (Items G4–G10) is provided for community floodplain management purposes.

| | | |
|-------------------------|------------------------------|---|
| G4. Permit Number _____ | G5. Date Permit Issued _____ | G6. Date Certificate Of Compliance/Occupancy Issued _____ |
|-------------------------|------------------------------|---|

G7. This permit has been issued for: New Construction Substantial Improvement

G8. Elevation of as-built lowest floor (including basement) of the building: _____ feet meters Datum _____

G9. BFE or (in Zone AO) depth of flooding at the building site: _____ feet meters Datum _____

G10. Community's design flood elevation: _____

Local Official's Name _____ Title _____

Community Name _____ Telephone _____

Signature _____ Date _____

Comments _____

Check here if attachments.

Replaces all previous editions.

ELEVATION CERTIFICATE

IMPORTANT: Follow the instructions on pages 1-9.

OMB No. 1660-0008
 Expiration Date: July 31, 2015

529 Camille Circle **SECTION A - PROPERTY INFORMATION**

A1. Building Owner's Name The Housing Authority of the City of Waveland

A2. Building Street Address (including Apt., Unit, Suite, and/or Bldg. No.) or P.O. Route and Box No.
500 Camille Court, Building No.11

City Waveland State MS ZIP Code 39576

A3. Property Description (Lot and Block Numbers, Tax Parcel Number, Legal Description, etc.)
Part of Tax Parcel #162H-0-03-018.00

A4. Building Use (e.g., Residential, Non-Residential, Addition, Accessory, etc.) Residential

A5. Latitude/Longitude: Lat. 30d17'13.3" Long. 89d22'41.7" Horizontal Datum: NAD 1927 NAD 1983

A6. Attach at least 2 photographs of the building if the Certificate is being used to obtain flood insurance.

A7. Building Diagram Number 1A

A8. For a building with a crawlspace or enclosure(s):
 a) Square footage of crawlspace or enclosure(s) na sq ft
 b) Number of permanent flood openings in the crawlspace or enclosure(s) within 1.0 foot above adjacent grade na
 c) Total net area of flood openings in A8.b na sq in
 d) Engineered flood openings? Yes No

A9. For a building with an attached garage:
 a) Square footage of attached garage na sq ft
 b) Number of permanent flood openings in the attached garage within 1.0 foot above adjacent grade na
 c) Total net area of flood openings in A9.b na sq in
 d) Engineered flood openings? Yes No

SECTION B - FLOOD INSURANCE RATE MAP (FIRM) INFORMATION

B1. NFIP Community Name & Community Number
City of Waveland 285262

B2. County Name
Hancock

B3. State
Ms

B4. Map/Panel Number 28045C0342

B5. Suffix D

B6. FIRM Index Date 10/16/2009

B7. FIRM Panel Effective/Revised Date 10/16/2009

B8. Flood Zone(s) AE

B9. Base Flood Elevation(s) (Zone AO, use base flood depth) 18

B10. Indicate the source of the Base Flood Elevation (BFE) data or base flood depth entered in Item B9:
 FIS Profile FIRM Community Determined Other/Source: _____

B11. Indicate elevation datum used for BFE in Item B9: NGVD 1929 NAVD 1988 Other/Source: _____

B12. Is the building located in a Coastal Barrier Resources System (CBRS) area or Otherwise Protected Area (OPA)? Yes No
 Designation Date: _____ / _____ / _____ CBRS OPA

SECTION C - BUILDING ELEVATION INFORMATION (SURVEY REQUIRED)

C1. Building elevations are based on: Construction Drawings* Building Under Construction* Finished Construction
 *A new Elevation Certificate will be required when construction of the building is complete.

C2. Elevations - Zones A1-A30, AE, AH, A (with BFE), VE, V1-V30, V (with BFE), AR, AR/A, AR/AE, AR/A1-A30, AR/AH, AR/AO. Complete Items C2.a-h below according to the building diagram specified in Item A7. In Puerto Rico only, enter meters.

Benchmark Utilized: GPS RTK-Trimble VRS Network Vertical Datum: NAVD 1988

Indicate elevation datum used for the elevations in items a) through h) below. NGVD 1929 NAVD 1988 Other/Source: _____
 Datum used for building elevations must be the same as that used for the BFE.

Check the measurement used.

a) Top of bottom floor (including basement, crawlspace, or enclosure floor) 19 . 5 feet meters

b) Top of the next higher floor na feet meters

c) Bottom of the lowest horizontal structural member (V Zones only) na feet meters

d) Attached garage (top of slab) na feet meters

e) Lowest elevation of machinery or equipment servicing the building (Describe type of equipment and location in Comments) 19 . 5 feet meters

f) Lowest adjacent (finished) grade next to building (LAG) 17 . 0 feet meters

g) Highest adjacent (finished) grade next to building (HAG) 17 . 1 feet meters

h) Lowest adjacent grade at lowest elevation of deck or stairs, including structural support na feet meters

SECTION D - SURVEYOR, ENGINEER, OR ARCHITECT CERTIFICATION

This certification is to be signed and sealed by a land surveyor, engineer, or architect authorized by law to certify elevation information. I certify that the information on this Certificate represents my best efforts to interpret the data available. I understand that any false statement may be punishable by fine or imprisonment under 18 U.S. Code, Section 1001.

Check here if comments are provided on back of form. Were latitude and longitude in Section A provided by a licensed land surveyor? Yes No

Check here if attachments.

| | | | |
|---|--|---------------------------------------|--------------------------|
| Certifier's Name <u>Paul A. Liles</u> | | License Number <u>3174</u> | |
| Title <u>Professional Surveyor</u> | | Company Name <u>Machado Patano</u> | |
| Address <u>1641 Popp's Ferry Road, Suite A-4</u> | | City <u>Biloxi</u> | State <u>MS</u> |
| Signature <u>Paul A. Liles</u> | | Date <u>07/09/2015</u> | ZIP Code <u>39532</u> |
| | | Telephone <u>(228) 388-1950</u> | |

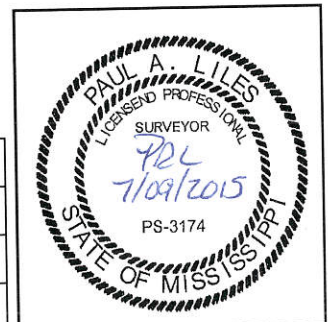

ELEVATION CERTIFICATE, page 2

| | | | |
|--|----------------------------------|-------------------|----------------------|
| IMPORTANT: In these spaces, copy the corresponding information from Section A. | FOR INSURANCE COMPANY USE | | |
| Building Street Address (including Apt., Unit, Suite, and/or Bldg. No.) or P.O. Route and Box No. 500 Camille Court, Building No.11 | Policy Number: | | |
| City Waveland | State MS | ZIP Code 39576 | Company NAIC Number: |

SECTION D – SURVEYOR, ENGINEER, OR ARCHITECT CERTIFICATION (CONTINUED)

Copy both sides of this Elevation Certificate for (1) community official, (2) insurance agent/company, and (3) building owner.

Comments C2e= proposed air conditioner pad
C2f and g)=existing grades

Signature Paul A. Est Date 07/09/2015

SECTION E – BUILDING ELEVATION INFORMATION (SURVEY NOT REQUIRED) FOR ZONE AO AND ZONE A (WITHOUT BFE)

For Zones AO and A (without BFE), complete Items E1–E5. If the Certificate is intended to support a LOMA or LOMR-F request, complete Sections A, B, and C. For Items E1–E4, use natural grade, if available. Check the measurement used. In Puerto Rico only, enter meters.

E1. Provide elevation information for the following and check the appropriate boxes to show whether the elevation is above or below the highest adjacent grade (HAG) and the lowest adjacent grade (LAG).

a) Top of bottom floor (including basement, crawlspace, or enclosure) is _____ . _____ feet meters above or below the HAG.

b) Top of bottom floor (including basement, crawlspace, or enclosure) is _____ . _____ feet meters above or below the LAG.

E2. For Building Diagrams 6–9 with permanent flood openings provided in Section A Items 8 and/or 9 (see pages 8–9 of Instructions), the next higher floor (elevation C2.b in the diagrams) of the building is _____ . _____ feet meters above or below the HAG.

E3. Attached garage (top of slab) is _____ . _____ feet meters above or below the HAG.

E4. Top of platform of machinery and/or equipment servicing the building is _____ . _____ feet meters above or below the HAG.

E5. Zone AO only: If no flood depth number is available, is the top of the bottom floor elevated in accordance with the community's floodplain management ordinance? Yes No Unknown. The local official must certify this information in Section G.

SECTION F – PROPERTY OWNER (OR OWNER'S REPRESENTATIVE) CERTIFICATION

The property owner or owner's authorized representative who completes Sections A, B, and E for Zone A (without a FEMA-issued or community-issued BFE) or Zone AO must sign here. The statements in Sections A, B, and E are correct to the best of my knowledge.

Property Owner or Owner's Authorized Representative's Name _____

| | | | |
|-----------------|------------|-----------------|----------------|
| Address _____ | City _____ | State _____ | ZIP Code _____ |
| Signature _____ | Date _____ | Telephone _____ | |

Comments _____ Check here if attachments.

SECTION G – COMMUNITY INFORMATION (OPTIONAL)

The local official who is authorized by law or ordinance to administer the community's floodplain management ordinance can complete Sections A, B, C (or E), and G of this Elevation Certificate. Complete the applicable item(s) and sign below. Check the measurement used in Items G8–G10. In Puerto Rico only, enter meters.

G1. The information in Section C was taken from other documentation that has been signed and sealed by a licensed surveyor, engineer, or architect who is authorized by law to certify elevation information. (Indicate the source and date of the elevation data in the Comments area below.)

G2. A community official completed Section E for a building located in Zone A (without a FEMA-issued or community-issued BFE) or Zone AO.

G3. The following information (Items G4–G10) is provided for community floodplain management purposes.

| | | |
|-------------------------|------------------------------|---|
| G4. Permit Number _____ | G5. Date Permit Issued _____ | G6. Date Certificate Of Compliance/Occupancy Issued _____ |
|-------------------------|------------------------------|---|

G7. This permit has been issued for: New Construction Substantial Improvement

G8. Elevation of as-built lowest floor (including basement) of the building: _____ . _____ feet meters Datum _____

G9. BFE or (in Zone AO) depth of flooding at the building site: _____ . _____ feet meters Datum _____

G10. Community's design flood elevation: _____ . _____ feet meters Datum _____

| | |
|-----------------------------|-----------------|
| Local Official's Name _____ | Title _____ |
| Community Name _____ | Telephone _____ |
| Signature _____ | Date _____ |

Comments _____ Check here if attachments.