

ELEVATION CERTIFICATE

Important: Read the instructions on pages 1-9.

OMB No. 1660-0008
 Expiration Date: July 31, 2015

SECTION A - PROPERTY INFORMATION

FOR INSURANCE COMPANY USE

A1. Building Owner's Name JOANN THOMPSON

Policy Number:

A2. Building Street Address (including Apt., Unit, Suite, and/or Bldg. No.) or P.O. Route and Box No.
112 AIKEN ST

Company NAIC Number:

City Waveland

State MS

ZIP Code 39576

A3. Property Description (Lot and Block Numbers, Tax Parcel Number, Legal Description, etc.)
TAX PARCEL # (161B-2-01-048.000)

A4. Building Use (e.g., Residential, Non-Residential, Addition, Accessory, etc.) Residential

Horizontal Datum: NAD 1927 NAD 1983

A5. Latitude/Longitude: Lat. N 30-17-31 Long. W 89-21-13

A6. Attach at least 2 photographs of the building if the Certificate is being used to obtain flood insurance.

A7. Building Diagram Number 6

A8. For a building with a crawlspace or enclosure(s):

A9. For a building with an attached garage:

- a) Square footage of crawlspace or enclosure(s) 230 sq ft
- b) Number of permanent flood openings in the crawlspace or enclosure(s) within 1.0 foot above adjacent grade 3
- c) Total net area of flood openings in A8.b 283 sq in
- d) Engineered flood openings? Yes No

- a) Square footage of attached garage NA sq ft
- b) Number of permanent flood openings in the attached garage within 1.0 foot above adjacent grade NA
- c) Total net area of flood openings in A9.b NA sq in
- d) Engineered flood openings? Yes No

SECTION B - FLOOD INSURANCE RATE MAP (FIRM) INFORMATION

B1. NFIP Community Name & Community Number <u>Waveland 285262</u>		B2. County Name <u>Hancock</u>		B3. State <u>MS</u>	
B4. Map/Panel Number <u>28045C-0361</u>	B5. Suffix <u>D</u>	B6. FIRM Index Date <u>10-16-09</u>	B7. FIRM Panel Effective/Revised Date <u>10-16-09</u>	B8. Flood Zone(s) <u>AE</u>	B9. Base Flood Elevation(s) (Zone AO, use base flood depth) <u>20</u>

B10. Indicate the source of the Base Flood Elevation (BFE) data or base flood depth entered in Item B9.
 FIS Profile FIRM Community Determined Other/Source: _____

B11. Indicate elevation datum used for BFE in Item B9: NGVD 1929 NAVD 1988 Other/Source: _____

B12. Is the building located in a Coastal Barrier Resources System (CBRS) area or Otherwise Protected Area (OPA)? Yes No
 Designation Date: NA CBRS OPA

SECTION C - BUILDING ELEVATION INFORMATION (SURVEY REQUIRED)

C1. Building elevations are based on: Construction Drawings* Building Under Construction* Finished Construction
 *A new Elevation Certificate will be required when construction of the building is complete.

C2. Elevations - Zones A1-A30, AE, AH, A (with BFE), VE, V1-V30, V (with BFE), AR, AR/A, AR/AE, AR/A1-A30, AR/AH, AR/AO. Complete Items C2.a-h below according to the building diagram specified in Item A7. In Puerto Rico only, enter meters.

Benchmark Utilized: LOCAL

Vertical Datum: NAVD 1988

Indicate elevation datum used for the elevations in items a) through h) below. NGVD 1929 NAVD 1988 Other/Source: _____
 Datum used for building elevations must be the same as that used for the BFE.

Check the measurement used.

- a) Top of bottom floor (including basement, crawlspace, or enclosure floor) 14.1 feet meters
- b) Top of the next higher floor 26.5 feet meters
- c) Bottom of the lowest horizontal structural member (V Zones only) NA feet meters
- d) Attached garage (top of slab) NA feet meters
- e) Lowest elevation of machinery or equipment servicing the building (Describe type of equipment and location in Comments) 26.3 feet meters
- f) Lowest adjacent (finished) grade next to building (LAG) 13.7 feet meters
- g) Highest adjacent (finished) grade next to building (HAG) 14.5 feet meters
- h) Lowest adjacent grade at lowest elevation of deck or stairs, including structural support 14.1 feet meters

SECTION D - SURVEYOR, ENGINEER, OR ARCHITECT CERTIFICATION

This certification is to be signed and sealed by a land surveyor, engineer, or architect authorized by law to certify elevation information. I certify that the information on this Certificate represents my best efforts to interpret the data available. I understand that any false statement may be punishable by fine or imprisonment under 18 U.S. Code, Section 1001.

- Check here if comments are provided on back of form. Were latitude and longitude in Section A provided by a licensed land surveyor? Yes No
- Check here if attachments.

Certifier's Name Duke Levy License Number 01722
 Title Surveyor Company Name Duke Levy & Associates
 Address 1711 Waveland Ave. City Waveland State MS ZIP Code 39576
 Signature [Signature] Date 8-21-14 Telephone 228-467-5212



ELEVATION CERTIFICATE, page 2

IMPORTANT: In these spaces, copy the corresponding information from Section A.	FOR INSURANCE COMPANY USE
Building Street Address (including Apt., Unit, Suite, and/or Bldg. No.) or P.O. Route and Box No. 112 AIKEN ST	Policy Number:
City Waveland State MS ZIP Code 39576	Company NAIC Number:

SECTION D – SURVEYOR, ENGINEER, OR ARCHITECT CERTIFICATION (CONTINUED)

Copy both sides of this Elevation Certificate for (1) community official, (2) insurance agent/company, and (3) building owner.

Comments PROJECT # 1001185
A/C IS LOWEST MACHINERY

Signature Date 8-21-14

SECTION E – BUILDING ELEVATION INFORMATION (SURVEY NOT REQUIRED) FOR ZONE AO AND ZONE A (WITHOUT BFE)

For Zones AO and A (without BFE), complete Items E1–E5. If the Certificate is intended to support a LOMA or LOMR-F request, complete Sections A, B, and C. For Items E1–E4, use natural grade, if available. Check the measurement used. In Puerto Rico only, enter meters.

- E1. Provide elevation information for the following and check the appropriate boxes to show whether the elevation is above or below the highest adjacent grade (HAG) and the lowest adjacent grade (LAG).
 - a) Top of bottom floor (including basement, crawlspace, or enclosure) is _____ feet meters above or below the HAG.
 - b) Top of bottom floor (including basement, crawlspace, or enclosure) is _____ feet meters above or below the LAG.
- E2. For Building Diagrams 6–9 with permanent flood openings provided in Section A Items 8 and/or 9 (see pages 8–9 of Instructions), the next higher floor (elevation C2.b in the diagrams) of the building is _____ feet meters above or below the HAG.
- E3. Attached garage (top of slab) is _____ feet meters above or below the HAG.
- E4. Top of platform of machinery and/or equipment servicing the building is _____ feet meters above or below the HAG.
- E5. Zone AO only: If no flood depth number is available, is the top of the bottom floor elevated in accordance with the community's floodplain management ordinance? Yes No Unknown. The local official must certify this information in Section G.

SECTION F – PROPERTY OWNER (OR OWNER'S REPRESENTATIVE) CERTIFICATION

The property owner or owner's authorized representative who completes Sections A, B, and E for Zone A (without a FEMA-issued or community-issued BFE) or Zone AO must sign here. The statements in Sections A, B, and E are correct to the best of my knowledge.

Property Owner's or Owner's Authorized Representative's Name _____

Address _____ City _____ State _____ ZIP Code _____

Signature _____ Date _____ Telephone _____

Comments _____ Check here if attachments.

SECTION G – COMMUNITY INFORMATION (OPTIONAL)

The local official who is authorized by law or ordinance to administer the community's floodplain management ordinance can complete Sections A, B, C (or E), and G of this Elevation Certificate. Complete the applicable item(s) and sign below. Check the measurement used in Items G8–G10. In Puerto Rico only, enter meters.

- G1. The information in Section C was taken from other documentation that has been signed and sealed by a licensed surveyor, engineer, or architect who is authorized by law to certify elevation information. (Indicate the source and date of the elevation data in the Comments area below.)
- G2. A community official completed Section E for a building located in Zone A (without a FEMA-issued or community-issued BFE) or Zone AO.
- G3. The following information (Items G4–G10) is provided for community floodplain management purposes.

G4. Permit Number	G5. Date Permit Issued	G6. Date Certificate Of Compliance/Occupancy Issued
-------------------	------------------------	---

- G7. This permit has been issued for: New Construction Substantial Improvement
- G8. Elevation of as-built lowest floor (including basement) of the building: _____ feet meters Datum _____
- G9. BFE or (in Zone AO) depth of flooding at the building site: _____ feet meters Datum _____
- G10. Community's design flood elevation: _____ feet meters Datum _____

Local Official's Name _____ Title _____

Community Name _____ Telephone _____

Signature _____ Date _____

Comments _____ Check here if attachments.

Building Photographs

See Instructions for Item A6.

IMPORTANT: In these spaces, copy the corresponding information from Section A.

Building Street Address (including Apt., Unit, Suite, and/or Bldg. No.) or P.O. Route and Box No.
112 AIKEN ST

City Waveland

State MS ZIP Code 39576

FOR INSURANCE COMPANY USE	
Policy Number:	
Company NAIC Number:	

If using the Elevation Certificate to obtain NFIP flood insurance, affix at least 2 building photographs below according to the instructions for Item A6. Identify all photographs with date taken; "Front View" and "Rear View"; and, if required, "Right Side View" and "Left Side View." When applicable, photographs must show the foundation with representative examples of the flood openings or vents, as indicated in Section A8. If submitting more photographs than will fit on this page, use the Continuation Page.



ELEVATION CERTIFICATE

Important: Read the instructions on pages 1-9.

OMB No. 1660-0008
 Expiration Date: July 31, 2015

SECTION A - PROPERTY INFORMATION

FOR INSURANCE COMPANY USE	
Policy Number:	
Company NAIC Number:	

A1. Building Owner's Name JOANN THOMPSON

A2. Building Street Address (including Apt., Unit, Suite, and/or Bldg. No.) or P.O. Route and Box No.
112 AIKEN ST
 City Waveland State MS ZIP Code 39576

A3. Property Description (Lot and Block Numbers, Tax Parcel Number, Legal Description, etc.)
TAX PARCEL # (161B-2-01-048.000)

A4. Building Use (e.g., Residential, Non-Residential, Addition, Accessory, etc.) Residential Horizontal Datum: NAD 1927 NAD 1983

A5. Latitude/Longitude: Lat. N 30-17-31 Long. W 89-21-13

A6. Attach at least 2 photographs of the building if the Certificate is being used to obtain flood insurance.

A7. Building Diagram Number 6

A8. For a building with a crawlspace or enclosure(s):

a) Square footage of crawlspace or enclosure(s)	<u>230</u>	sq ft
b) Number of permanent flood openings in the crawlspace or enclosure(s) within 1.0 foot above adjacent grade	<u>NA</u>	
c) Total net area of flood openings in A8.b	<u>NA</u>	sq in
d) Engineered flood openings?	<input type="checkbox"/> Yes <input checked="" type="checkbox"/> No	

A9. For a building with an attached garage:

a) Square footage of attached garage	<u>NA</u>	sq ft
b) Number of permanent flood openings in the attached garage within 1.0 foot above adjacent grade	<u>NA</u>	
c) Total net area of flood openings in A9.b	<u>NA</u>	sq in
d) Engineered flood openings?	<input type="checkbox"/> Yes <input checked="" type="checkbox"/> No	

SECTION B - FLOOD INSURANCE RATE MAP (FIRM) INFORMATION

B1. NFIP Community Name & Community Number <u>Waveland 285262</u>		B2. County Name <u>Hancock</u>	B3. State <u>MS</u>
B4. Map/Panel Number <u>28045C-0361</u>	B5. Suffix <u>D</u>	B6. FIRM Index Date <u>10-16-09</u>	B7. FIRM Panel Effective/Revised Date <u>10-16-09</u>
B8. Flood Zone(s) <u>AE</u>		B9. Base Flood Elevation(s) (Zone AO, use base flood depth) <u>20</u>	

B10. Indicate the source of the Base Flood Elevation (BFE) data or base flood depth entered in Item B9.
 FIS Profile FIRM Community Determined Other/Source: _____

B11. Indicate elevation datum used for BFE in Item B9: NGVD 1929 NAVD 1988 Other/Source: _____

B12. Is the building located in a Coastal Barrier Resources System (CBRS) area or Otherwise Protected Area (OPA)? Yes No
 Designation Date: NA CBRS OPA

SECTION C - BUILDING ELEVATION INFORMATION (SURVEY REQUIRED)

C1. Building elevations are based on: Construction Drawings* Building Under Construction* Finished Construction
 *A new Elevation Certificate will be required when construction of the building is complete.

C2. Elevations - Zones A1-A30, AE, AH, A (with BFE), VE, V1-V30, V (with BFE), AR, AR/A, AR/AE, AR/A1-A30, AR/AH, AR/AO. Complete Items C2.a-h below according to the building diagram specified in Item A7. In Puerto Rico only, enter meters.
 Benchmark Utilized: LOCAL Vertical Datum: NAVD 1988
 Indicate elevation datum used for the elevations in items a) through h) below. NGVD 1929 NAVD 1988 Other/Source: _____
 Datum used for building elevations must be the same as that used for the BFE.

a) Top of bottom floor (including basement, crawlspace, or enclosure floor)	<u>14.1</u>	<input checked="" type="checkbox"/> feet <input type="checkbox"/> meters
b) Top of the next higher floor	<u>26.5</u>	<input checked="" type="checkbox"/> feet <input type="checkbox"/> meters
c) Bottom of the lowest horizontal structural member (V Zones only)	<u>NA</u>	<input checked="" type="checkbox"/> feet <input type="checkbox"/> meters
d) Attached garage (top of slab)	<u>NA</u>	<input checked="" type="checkbox"/> feet <input type="checkbox"/> meters
e) Lowest elevation of machinery or equipment servicing the building (Describe type of equipment and location in Comments)	<u>NA</u>	<input checked="" type="checkbox"/> feet <input type="checkbox"/> meters
f) Lowest adjacent (finished) grade next to building (LAG)	<u>13.7</u>	<input checked="" type="checkbox"/> feet <input type="checkbox"/> meters
g) Highest adjacent (finished) grade next to building (HAG)	<u>14.5</u>	<input checked="" type="checkbox"/> feet <input type="checkbox"/> meters
h) Lowest adjacent grade at lowest elevation of deck or stairs, including structural support	<u>14.1</u>	<input checked="" type="checkbox"/> feet <input type="checkbox"/> meters

SECTION D - SURVEYOR, ENGINEER, OR ARCHITECT CERTIFICATION

This certification is to be signed and sealed by a land surveyor, engineer, or architect authorized by law to certify elevation information. I certify that the information on this Certificate represents my best efforts to interpret the data available. I understand that any false statement may be punishable by fine or imprisonment under 18 U.S. Code, Section 1001.

Check here if comments are provided on back of form. Were latitude and longitude in Section A provided by a licensed land surveyor? Yes No

Check here if attachments.

Certifier's Name Duke Levy License Number 01722

Title Surveyor Company Name Duke Levy & Associates

Address 1711 Waveland Ave. City Waveland State MS ZIP Code 39576

Signature  Date 7-31-14 Telephone 228-467-5212



ELEVATION CERTIFICATE, page 2

IMPORTANT: In these spaces, copy the corresponding information from Section A.	FOR INSURANCE COMPANY USE
Building Street Address (including Apt., Unit, Suite, and/or Bldg. No.) or P.O. Route and Box No. 12 AIKEN ST	Policy Number:
City Waveland State MS ZIP Code 39576	Company NAIC Number:

SECTION D – SURVEYOR, ENGINEER, OR ARCHITECT CERTIFICATION (CONTINUED)

Copy both sides of this Elevation Certificate for (1) community official, (2) insurance agent/company, and (3) building owner.

Comments PROJECT # 1001185
TBM - MAG NAIL W/ DISK IN CENTERLINE OF RD AT PROP @ EL = 14.71' FEET

Signature Date 7-31-14

SECTION E – BUILDING ELEVATION INFORMATION (SURVEY NOT REQUIRED) FOR ZONE AO AND ZONE A (WITHOUT BFE)

For Zones AO and A (without BFE), complete Items E1–E5. If the Certificate is intended to support a LOMA or LOMR-F request, complete Sections A, B, and C. For Items E1–E4, use natural grade, if available. Check the measurement used. In Puerto Rico only, enter meters.

- E1. Provide elevation information for the following and check the appropriate boxes to show whether the elevation is above or below the highest adjacent grade (HAG) and the lowest adjacent grade (LAG).
 - a) Top of bottom floor (including basement, crawlspace, or enclosure) is _____ feet meters above or below the HAG.
 - b) Top of bottom floor (including basement, crawlspace, or enclosure) is _____ feet meters above or below the LAG.
- E2. For Building Diagrams 6–9 with permanent flood openings provided in Section A Items 8 and/or 9 (see pages 8–9 of Instructions), the next higher floor (elevation C2.b in the diagrams) of the building is _____ feet meters above or below the HAG.
- E3. Attached garage (top of slab) is _____ feet meters above or below the HAG.
- E4. Top of platform of machinery and/or equipment servicing the building is _____ feet meters above or below the HAG.
- E5. Zone AO only: If no flood depth number is available, is the top of the bottom floor elevated in accordance with the community's floodplain management ordinance? Yes No Unknown. The local official must certify this information in Section G.

SECTION F – PROPERTY OWNER (OR OWNER'S REPRESENTATIVE) CERTIFICATION

The property owner or owner's authorized representative who completes Sections A, B, and E for Zone A (without a FEMA-issued or community-issued BFE) or Zone AO must sign here. The statements in Sections A, B, and E are correct to the best of my knowledge.

Property Owner's or Owner's Authorized Representative's Name _____

Address _____ City _____ State _____ ZIP Code _____

Signature _____ Date _____ Telephone _____

Comments _____ Check here if attachments.

SECTION G – COMMUNITY INFORMATION (OPTIONAL)

The local official who is authorized by law or ordinance to administer the community's floodplain management ordinance can complete Sections A, B, C (or E), and G of this Elevation Certificate. Complete the applicable item(s) and sign below. Check the measurement used in Items G8–G10. In Puerto Rico only, enter meters.

- G1. The information in Section C was taken from other documentation that has been signed and sealed by a licensed surveyor, engineer, or architect who is authorized by law to certify elevation information. (Indicate the source and date of the elevation data in the Comments area below.)
- G2. A community official completed Section E for a building located in Zone A (without a FEMA-issued or community-issued BFE) or Zone AO.
- G3. The following information (Items G4–G10) is provided for community floodplain management purposes.

G4. Permit Number	G5. Date Permit Issued	G6. Date Certificate Of Compliance/Occupancy Issued
-------------------	------------------------	---

- G7. This permit has been issued for: New Construction Substantial Improvement
- G8. Elevation of as-built lowest floor (including basement) of the building: _____ feet meters Datum _____
- G9. BFE or (in Zone AO) depth of flooding at the building site: _____ feet meters Datum _____
- G10. Community's design flood elevation: _____ feet meters Datum _____

Local Official's Name _____ Title _____

Community Name _____ Telephone _____

Signature _____ Date _____

Comments _____ Check here if attachments.

ELEVATION CERTIFICATE

OMB No. 1660-0008
 Expiration Date: July 31, 2015

Important: Read the instructions on pages 1-9.

SECTION A - PROPERTY INFORMATION

FOR INSURANCE COMPANY USE	
Policy Number:	
Company NAIC Number:	

A1. Building Owner's Name JOANN THOMPSON

A2. Building Street Address (including Apt., Unit, Suite, and/or Bldg. No.) or P.O. Route and Box No.
112 AIKEN ST State MS ZIP Code 39576
 City Waveland

A3. Property Description (Lot and Block Numbers, Tax Parcel Number, Legal Description, etc.)
TAX PARCEL # (161B-2-01-048.000)

A4. Building Use (e.g., Residential, Non-Residential, Addition, Accessory, etc.) Residential Horizontal Datum: NAD 1927 NAD 1983

A5. Latitude/Longitude: Lat. N 30-17-31 Long. W 89-21-13

A6. Attach at least 2 photographs of the building if the Certificate is being used to obtain flood insurance.

A7. Building Diagram Number 5

A8. For a building with a crawlspace or enclosure(s):

a) Square footage of crawlspace or enclosure(s)	<u>NA</u>	sq ft
b) Number of permanent flood openings in the crawlspace or enclosure(s) within 1.0 foot above adjacent grade	<u>NA</u>	
c) Total net area of flood openings in A8.b	<u>NA</u>	sq in
d) Engineered flood openings?	<input type="checkbox"/> Yes <input checked="" type="checkbox"/> No	

A9. For a building with an attached garage:

a) Square footage of attached garage	<u>NA</u>	sq ft
b) Number of permanent flood openings in the attached garage within 1.0 foot above adjacent grade	<u>NA</u>	
c) Total net area of flood openings in A9.b	<u>NA</u>	sq in
d) Engineered flood openings?	<input type="checkbox"/> Yes <input checked="" type="checkbox"/> No	

SECTION B - FLOOD INSURANCE RATE MAP (FIRM) INFORMATION

B1. NFIP Community Name & Community Number <u>Waveland 285262</u>		B2. County Name <u>Hancock</u>		B3. State <u>MS</u>	
B4. Map/Panel Number <u>28045C-0361</u>	B5. Suffix <u>D</u>	B6. FIRM Index Date <u>10-16-09</u>	B7. FIRM Panel Effective/Revised Date <u>10-16-09</u>	B8. Flood Zone(s) <u>AE</u>	B9. Base Flood Elevation(s) (Zone AO, use base flood depth) <u>20</u>

B10. Indicate the source of the Base Flood Elevation (BFE) data or base flood depth entered in Item B9.
 FIS Profile FIRM Community Determined Other/Source: _____

B11. Indicate elevation datum used for BFE in Item B9: NGVD 1929 NAVD 1988 Other/Source: _____ Yes No

B12. Is the building located in a Coastal Barrier Resources System (CBRS) area or Otherwise Protected Area (OPA)?
 CBRS OPA
 Designation Date: NA

SECTION C - BUILDING ELEVATION INFORMATION (SURVEY REQUIRED)

C1. Building elevations are based on: Construction Drawings* Building Under Construction* Finished Construction
 *A new Elevation Certificate will be required when construction of the building is complete.

C2. Elevations - Zones A1-A30, AE, AH, A (with BFE), VE, V1-V30, V (with BFE), AR, AR/A, AR/AE, AR/A1-A30, AR/AH, AR/AO. Complete Items C2.a-h below according to the building diagram specified in Item A7. In Puerto Rico only, enter meters.

Benchmark Utilized: LOCAL Vertical Datum: NAVD 1988
 Indicate elevation datum used for the elevations in items a) through h) below. NGVD 1929 NAVD 1988 Other/Source: _____
 Datum used for building elevations must be the same as that used for the BFE.

Check the measurement used.

a) Top of bottom floor (including basement, crawlspace, or enclosure floor)	<u>24.0</u>	<input checked="" type="checkbox"/> feet <input type="checkbox"/> meters
b) Top of the next higher floor	<u>NA</u>	<input checked="" type="checkbox"/> feet <input type="checkbox"/> meters
c) Bottom of the lowest horizontal structural member (V Zones only)	<u>NA</u>	<input checked="" type="checkbox"/> feet <input type="checkbox"/> meters
d) Attached garage (top of slab)	<u>NA</u>	<input checked="" type="checkbox"/> feet <input type="checkbox"/> meters
e) Lowest elevation of machinery or equipment servicing the building (Describe type of equipment and location in Comments)	<u>NA</u>	<input checked="" type="checkbox"/> feet <input type="checkbox"/> meters
f) Lowest adjacent (finished) grade next to building (LAG)	<u>13.7</u>	<input checked="" type="checkbox"/> feet <input type="checkbox"/> meters
g) Highest adjacent (finished) grade next to building (HAG)	<u>14.5</u>	<input checked="" type="checkbox"/> feet <input type="checkbox"/> meters
h) Lowest adjacent grade at lowest elevation of deck or stairs, including structural support	<u>NA</u>	<input checked="" type="checkbox"/> feet <input type="checkbox"/> meters

SECTION D - SURVEYOR, ENGINEER, OR ARCHITECT CERTIFICATION

This certification is to be signed and sealed by a land surveyor, engineer, or architect authorized by law to certify elevation information. I certify that the information on this Certificate represents my best efforts to interpret the data available. I understand that any false statement may be punishable by fine or imprisonment under 18 U.S. Code, Section 1001.

Check here if comments are provided on back of form. Were latitude and longitude in Section A provided by a licensed land surveyor? Yes No

Check here if attachments.

Certifier's Name Duke Levy License Number 01722

Title Surveyor Company Name Duke Levy & Associates

Address 1711 Waveland Ave. City Waveland State MS ZIP Code 39576

Signature [Signature] Date 3-25-14 Telephone 228-467-5212

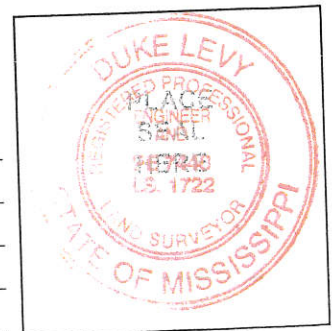

ELEVATION CERTIFICATE, page 2

IMPORTANT: In these spaces, copy the corresponding information from Section A. Building Street Address (including Apt., Unit, Suite, and/or Bldg. No.) or P.O. Route and Box No. 112 AIKEN ST City Waveland	FOR INSURANCE COMPANY USE
	Policy Number:
	Company NAIC Number:

SECTION D – SURVEYOR, ENGINEER, OR ARCHITECT CERTIFICATION (CONTINUED)

Copy both sides of this Elevation Certificate for (1) community official, (2) insurance agent/company, and (3) building owner.

Comments WO # 13-1076
TBM - MAG NAIL W/DISK SET IN CENTERLINE OF RD @ PROP @ EL = 14.71' FEET

Signature  Date 3-25-14

SECTION E – BUILDING ELEVATION INFORMATION (SURVEY NOT REQUIRED) FOR ZONE AO AND ZONE A (WITHOUT BFE)

For Zones AO and A (without BFE), complete Items E1–E5. If the Certificate is intended to support a LOMA or LOMR-F request, complete Sections A, B, and C. For Items E1–E4, use natural grade, if available. Check the measurement used. In Puerto Rico only, enter meters.

- E1. Provide elevation information for the following and check the appropriate boxes to show whether the elevation is above or below the highest adjacent grade (HAG) and the lowest adjacent grade (LAG).
 - a) Top of bottom floor (including basement, crawlspace, or enclosure) is _____ feet meters above or below the HAG.
 - b) Top of bottom floor (including basement, crawlspace, or enclosure) is _____ feet meters above or below the LAG.
- E2. For Building Diagrams 6–9 with permanent flood openings provided in Section A Items 8 and/or 9 (see pages 8–9 of Instructions), the next higher floor (elevation C2.b in the diagrams) of the building is _____ feet meters above or below the HAG.
- E3. Attached garage (top of slab) is _____ feet meters above or below the HAG.
- E4. Top of platform of machinery and/or equipment servicing the building is _____ feet meters above or below the HAG.
- E5. Zone AO only: If no flood depth number is available, is the top of the bottom floor elevated in accordance with the community's floodplain management ordinance? Yes No Unknown. The local official must certify this information in Section G.

SECTION F – PROPERTY OWNER (OR OWNER'S REPRESENTATIVE) CERTIFICATION

The property owner or owner's authorized representative who completes Sections A, B, and E for Zone A (without a FEMA-issued or community-issued BFE) or Zone AO must sign here. The statements in Sections A, B, and E are correct to the best of my knowledge.

Property Owner's or Owner's Authorized Representative's Name _____

Address _____	City _____	State _____	ZIP Code _____
Signature _____	Date _____	Telephone _____	

Comments _____ Check here if attachments.

SECTION G – COMMUNITY INFORMATION (OPTIONAL)

The local official who is authorized by law or ordinance to administer the community's floodplain management ordinance can complete Sections A, B, C (or E), and G of this Elevation Certificate. Complete the applicable item(s) and sign below. Check the measurement used in Items G8–G10. In Puerto Rico only, enter meters.

- G1. The information in Section C was taken from other documentation that has been signed and sealed by a licensed surveyor, engineer, or architect who is authorized by law to certify elevation information. (Indicate the source and date of the elevation data in the Comments area below.)
- G2. A community official completed Section E for a building located in Zone A (without a FEMA-issued or community-issued BFE) or Zone AO.
- G3. The following information (Items G4–G10) is provided for community floodplain management purposes.

G4. Permit Number _____	G5. Date Permit Issued _____	G6. Date Certificate Of Compliance/Occupancy Issued _____
-------------------------	------------------------------	---

G7. This permit has been issued for: New Construction Substantial Improvement

G8. Elevation of as-built lowest floor (including basement) of the building: _____ feet meters Datum _____

G9. BFE or (in Zone AO) depth of flooding at the building site: _____ feet meters Datum _____

G10. Community's design flood elevation: _____

Local Official's Name _____	Title _____
Community Name _____	Telephone _____
Signature _____	Date _____

Comments _____ Check here if attachments.

ELEVATION CERTIFICATE

OMB No. 1660-0008
 Expiration Date: July 31, 2015

Important: Read the instructions on pages 1-9.

SECTION A - PROPERTY INFORMATION

FOR INSURANCE COMPANY USE
 Policy Number:
 Company NAIC Number:

A1. Building Owner's Name JASON GARCIA
 A2. Building Street Address (including Apt., Unit, Suite, and/or Bldg. No.) or P.O. Route and Box No.
112 AIKEN ST
 City Waveland State MS ZIP Code 39576

A3. Property Description (Lot and Block Numbers, Tax Parcel Number, Legal Description, etc.)
 TAX PARCEL # (161B-2-01-048.000)

A4. Building Use (e.g., Residential, Non-Residential, Addition, Accessory, etc.) Residential
 Horizontal Datum: NAD 1927 NAD 1983
 A5. Latitude/Longitude: Lat. N 30-17-31 Long. W 89-21-13
 A6. Attach at least 2 photographs of the building if the Certificate is being used to obtain flood insurance.
 A7. Building Diagram Number 5
 A8. For a building with a crawlspace or enclosure(s):
 a) Square footage of crawlspace or enclosure(s) NA sq ft
 b) Number of permanent flood openings in the crawlspace or enclosure(s) within 1.0 foot above adjacent grade NA
 c) Total net area of flood openings in A8.b NA sq in
 d) Engineered flood openings? Yes No
 A9. For a building with an attached garage:
 a) Square footage of attached garage NA sq ft
 b) Number of permanent flood openings in the attached garage within 1.0 foot above adjacent grade NA
 c) Total net area of flood openings in A9.b NA sq in
 d) Engineered flood openings? Yes No

SECTION B - FLOOD INSURANCE RATE MAP (FIRM) INFORMATION

B1. NFIP Community Name & Community Number
Waveland 285262
 B2. County Name
Hancock
 B3. State
MS
 B4. Map/Panel Number
28045C-0361
 B5. Suffix
D
 B6. FIRM Index Date
10-16-09
 B7. FIRM Panel Effective/Revised Date
10-16-09
 B8. Flood Zone(s)
AE
 B9. Base Flood Elevation(s) (Zone AO, use base flood depth)
20

B10. Indicate the source of the Base Flood Elevation (BFE) data or base flood depth entered in Item B9.
 FIS Profile FIRM Community Determined Other/Source: _____
 B11. Indicate elevation datum used for BFE in Item B9: NGVD 1929 NAVD 1988 Other/Source: _____
 Yes No
 B12. Is the building located in a Coastal Barrier Resources System (CBRS) area or Otherwise Protected Area (OPA)?
 CBRS OPA
 Designation Date: NA

SECTION C - BUILDING ELEVATION INFORMATION (SURVEY REQUIRED)

C1. Building elevations are based on: Construction Drawings* Building Under Construction* Finished Construction
 *A new Elevation Certificate will be required when construction of the building is complete.
 C2. Elevations - Zones A1-A30, AE, AH, A (with BFE), VE, V1-V30, V (with BFE), AR, AR/A, AR/AE, AR/A1-A30, AR/AH, AR/AO. Complete Items C2.a-h below according to the building diagram specified in Item A7. In Puerto Rico only, enter meters.
 Benchmark Utilized: LOCAL
 Vertical Datum: NAVD 1988
 Indicate elevation datum used for the elevations in items a) through h) below. NGVD 1929 NAVD 1988 Other/Source: _____
 Datum used for building elevations must be the same as that used for the BFE.
 Check the measurement used.
 a) Top of bottom floor (including basement, crawlspace, or enclosure floor) 24.0 feet meters
NA feet meters
 b) Top of the next higher floor NA feet meters
NA feet meters
 c) Bottom of the lowest horizontal structural member (V Zones only) NA feet meters
NA feet meters
 d) Attached garage (top of slab) NA feet meters
 e) Lowest elevation of machinery or equipment servicing the building (Describe type of equipment and location in Comments) 13.7 feet meters
 f) Lowest adjacent (finished) grade next to building (LAG) 14.5 feet meters
 g) Highest adjacent (finished) grade next to building (HAG) NA feet meters
 h) Lowest adjacent grade at lowest elevation of deck or stairs, including structural support NA feet meters

SECTION D - SURVEYOR, ENGINEER, OR ARCHITECT CERTIFICATION

This certification is to be signed and sealed by a land surveyor, engineer, or architect authorized by law to certify elevation information. I certify that the information on this Certificate represents my best efforts to interpret the data available. I understand that any false statement may be punishable by fine or imprisonment under 18 U.S. Code, Section 1001.

Check here if comments are provided on back of form. Were latitude and longitude in Section A provided by a licensed land surveyor? Yes No
 Check here if attachments.
 Certifier's Name Duke Levy License Number 01722
 Title Surveyor Company Name Duke Levy & Associates
 Address 1711 Waveland Ave. City Waveland State MS ZIP Code 39576
 Signature [Signature] Date 11-27-13 Telephone 228-467-5212



ELEVATION CERTIFICATE, page 2

IMPORTANT: In these spaces, copy the corresponding information from Section A.	FOR INSURANCE COMPANY USE
Building Street Address (including Apt., Unit, Suite, and/or Bldg. No.) or P.O. Route and Box No. 112 AIKEN ST	Policy Number:
City Waveland	Company NAIC Number:
State MS ZIP Code 39576	

SECTION D – SURVEYOR, ENGINEER, OR ARCHITECT CERTIFICATION (CONTINUED)

Copy both sides of this Elevation Certificate for (1) community official, (2) insurance agent/company, and (3) building owner.

Comments WO # 13-1076
TBM - MAG NAIL W/DISK SET IN CENTERLINE OF RD @ PROP @ EL = 14.71' FEET

Signature Date 11-27-13

SECTION E – BUILDING ELEVATION INFORMATION (SURVEY NOT REQUIRED) FOR ZONE AO AND ZONE A (WITHOUT BFE)

- For Zones AO and A (without BFE), complete Items E1–E5. If the Certificate is intended to support a LOMA or LOMR-F request, complete Sections A, B, and C. For Items E1–E4, use natural grade, if available. Check the measurement used. In Puerto Rico only, enter meters.
- E1. Provide elevation information for the following and check the appropriate boxes to show whether the elevation is above or below the highest adjacent grade (HAG) and the lowest adjacent grade (LAG).
 a) Top of bottom floor (including basement, crawlspace, or enclosure) is _____ feet meters above or below the HAG.
 b) Top of bottom floor (including basement, crawlspace, or enclosure) is _____ feet meters above or below the LAG.
- E2. For Building Diagrams 6–9 with permanent flood openings provided in Section A Items 8 and/or 9 (see pages 8–9 of Instructions), the next higher floor (elevation C2.b in the diagrams) of the building is _____ feet meters above or below the HAG.
- E3. Attached garage (top of slab) is _____ feet meters above or below the HAG.
- E4. Top of platform of machinery and/or equipment servicing the building is _____ feet meters above or below the HAG.
- E5. Zone AO only: If no flood depth number is available, is the top of the bottom floor elevated in accordance with the community's floodplain management ordinance? Yes No Unknown. The local official must certify this information in Section G.

SECTION F – PROPERTY OWNER (OR OWNER'S REPRESENTATIVE) CERTIFICATION

The property owner or owner's authorized representative who completes Sections A, B, and E for Zone A (without a FEMA-issued or community-issued BFE) or Zone AO must sign here. The statements in Sections A, B, and E are correct to the best of my knowledge.

Property Owner's or Owner's Authorized Representative's Name _____

Address _____	City _____	State _____	ZIP Code _____
Signature _____	Date _____	Telephone _____	

Comments _____ Check here if attachments.

SECTION G – COMMUNITY INFORMATION (OPTIONAL)

The local official who is authorized by law or ordinance to administer the community's floodplain management ordinance can complete Sections A, B, C (or E), and G of this Elevation Certificate. Complete the applicable item(s) and sign below. Check the measurement used in Items G8–G10. In Puerto Rico only, enter meters.

- G1. The information in Section C was taken from other documentation that has been signed and sealed by a licensed surveyor, engineer, or architect who is authorized by law to certify elevation information. (Indicate the source and date of the elevation data in the Comments area below.)
- G2. A community official completed Section E for a building located in Zone A (without a FEMA-issued or community-issued BFE) or Zone AO.
- G3. The following information (Items G4–G10) is provided for community floodplain management purposes.

G4. Permit Number _____	G5. Date Permit Issued _____	G6. Date Certificate Of Compliance/Occupancy Issued _____
-------------------------	------------------------------	---

- G7. This permit has been issued for: New Construction Substantial Improvement
- G8. Elevation of as-built lowest floor (including basement) of the building: _____ feet meters Datum _____
- G9. BFE or (in Zone AO) depth of flooding at the building site: _____ feet meters Datum _____
- G10. Community's design flood elevation: _____ feet meters Datum _____

Local Official's Name _____	Title _____
Community Name _____	Telephone _____
Signature _____	Date _____

Comments _____ Check here if attachments.

WAVELAND NONCONVERSION AGREEMENT
with
CITY OF WAVELAND, MISSISSIPPI

This DECLARATION made this 11 day of Sept., 2014,
by Barrett Garcia ("Owner") having an address at
112 Aiken Rd.

WITNESSETH:

WHEREAS, the Owner is the record owner of all that real property located at
112 Aiken Rd in the City of Waveland, Ms. in the County of Hancock,
designated in the Tax Records as 161B-7-01-048.000

WHEREAS, the Owner has applied for a permit to place a structure on that property that has an
enclosed area below the base flood elevation constructed in accordance with the requirements of
Article No. 5, Section "B" paragraph 5 of the Waveland Floodplain Management Ordinance of Number
325 and under Permit Number 17129.

WHEREAS, the Owner agrees to record this DECLARATION and certifies and declares that the
following covenants, conditions and restrictions are placed on the affected property as a condition of
granting the Permit, and affects rights and obligations of the Owner and shall be binding on the Owner,
his heirs, personal representatives, successors, future owners, and assigns.

UPON THE TERMS AND SUBJECT TO THE CONDITIONS, as follows:

1. The structure or part thereof to which these conditions apply is:
2. At this site, the Base Flood Elevation is 70 feet above mean sea level, National Geodetic Vertical Datum.
3. Enclosed areas below the Base Flood Elevation shall be used solely for parking of vehicles, limited storage, or access to the building. All interior walls, ceilings and floors below the Base Flood Elevation shall be unfinished or constructed of flood resistant materials. Mechanical, electrical or plumbing devices shall not be installed below the Base Flood Elevation.
4. The walls of the enclosed areas below the Base Flood Elevation shall be equipped and remain equipped with openings as shown on the Permit.
5. The jurisdiction issuing the Permit and enforcing the Ordinance may take any appropriate legal action to correct any violation. Any alterations or changes from these conditions also may render the structure uninsurable or increase the cost for flood insurance.
6. A duly appointed representative of the City is authorized to enter the property for the purpose of inspecting the exterior and interior of the enclosed area to verify compliance with this Declaration. Such inspections will be conducted upon due notice to the Owner and no more frequently than once each year. More frequent inspections may be conducted if an annual inspection discovers a violation of the Permit.
7. Other conditions:

In witness whereof the undersigned set their hands and seals this 11th day of Sept., 2014.
Barrett Garcia
Owner

State of Mississippi, County of Hancock
(Seal) Personally appeared before me, the undersigned
authority in and for the said county and state,
on this 11 day of Sept, 2014, within
my jurisdiction, the within named Barrett Garcia
who acknowledged that Barrett Garcia executed the
above and foregoing instrument.



Timothy A. Kellar
Chancery Clerk
By: [Signature] CDC
My Commission Expires Dec. 31, 2015

WAVELAND

FLOODPLAIN VENTING AFFIDAVIT

City of Waveland

I hereby acknowledge that

Garett Garcia

is issuing an Occupancy Certificate for the property known as:

112 Aiken Rd

_____ under Permit #

17129

in which required Floodplain Management Ordinance requirements have been met and a final inspection performed. At the time of inspection, _____ vents and _____ crawl space access doors used to meet the flood venting requirements of the Ordinance would allow the automatic entry and exit of floodwaters. I acknowledge that all openings designed to meet this requirement must be maintained as flood vents, and that the elimination or alteration of the openings in any way that would no longer allow the automatic entry and exit of flood waters would violate the Flood Damage Prevention Ordinance. Violations may incur civil penalties and possible court action. In addition, I acknowledge that alteration of the vents could result in greater risk to my property and personal safety in the event of a flood. Flood insurance claims may be denied, and flood insurance may not be available or flood insurance premiums increase if vents are altered.

As witness the hand and seal of the owner of the subject property this

_____ day of _____,

WITNESS

OWNER (please print)

GGS

OWNER'S SIGNATURE